

Pebble Creek Golf Course 2nd Addition House Numbers

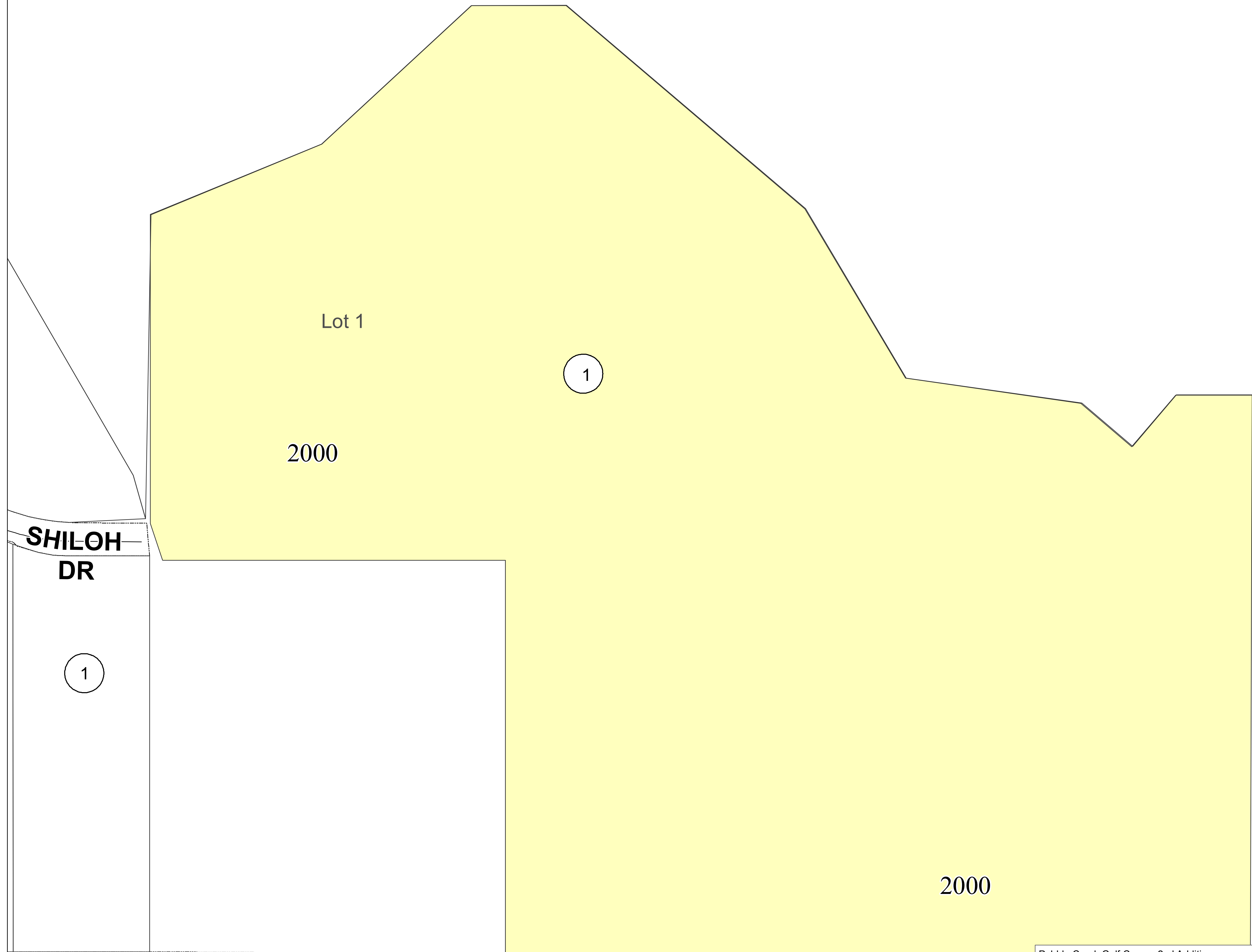

Pebble Creek Golf Course 2nd Addition was recorded on December 3, 2009.

This data is for representation only and does not represent a survey. No liability is assumed as to the accuracy of the data delineated hereon.

To ensure the accuracy of the data in this application, users are encouraged to provide feedback/information to the GIS Office.